



95 years of experience in sealing solutions

A reference in the industrial sealing sector, **GROUPE LATTY®** owes its leadership to its willingness to invest in Research & Development of specific products for your equipment. **GROUPE LATTY®** design and manufacture products that comply with the most demanding industrial requirements.

GROUPE LATTY® is present in the following sectors...

- PETROCHEMICALS
- ENERGY
- CHEMICALS
- PHARMACEUTICALS
- CRYOGENICS
- FOOD PROCESSING
- NUCLEAR ENERGY

and offers :

- Complete solutions suitable for each type of pumps
- Complete ranges of industry standard or custom specific products
- Research and testing laboratory
- Achieving type approval of your equipment
- Training adapted to your needs
- A French product, guarantee of quality

FORMATION



A well-trained employee is more skilful and efficient!

Training modules are more specifically dedicated to the selection of sealing solutions for industrial equipment. Oriented towards the implementation and good mounting practices, guarantee of security for your teams and the reliability of your equipment.

Each year many multilingual training, either in our plant or at customer centers are organized on:

- Valves
- Rotary units
- Bolted assemblies

We are an approved training organization.

LABORATORY R&D



Solutions tested on your equipment

GROUPE LATTY® invests an average of 5% of its annual turnover in Research and Development for new products and processes. The company has a test laboratory at its factory enabling it to test its products in optimum use conditions, including its clients' own equipment.

Research is essentially based on the resolution of clients' problems, which may be:

- to reduce friction loads,
- to use simple, efficient equipment,
- to reduce maintenance time,
- to have innovative products.

For several years, **GROUPE LATTY®** has invested in its own test laboratories, installed on over 500m², with more than 15 test cells, equipped with precision measurement equipment:

- pressure: from vacuum to 650 bars
- temperature: from -200°C to 650°C with the possibility to carry out thermal shocks
- speed: from 0 to 6000 rpm
- several helium mass spectrometers for leak measurement

GROUPE LATTY® is a member of the Fluid Sealing Association (FSA) and the European Sealing Association (ESA)

APPROVALS

Our different ranges of mechanicals seals comply with the following certifications, directives and standards:



SPLIT MECHANICAL SEALS

LATTY CARTseal® B25*



GROUPE LATTY® is developing its product range, offering you the **CARTseal® B25**, mechanical split seal, easy and fast to install.

Mechanical seals are sealing solutions commonly used in rotating equipment. They are subject to strains such as wear, corrosion, abrasion, vibration and other effects which require the best choice.

When sealing interventions are difficult to access or can lead to long production stoppages, **LATTY CARTseal® B25 mechanical split seal is the answer.**

ADVANTAGES

- Simple, fast and easy to install.
- Reduction in maintenance time.
- Only two sub-assemblies to manipulate
- Factory pre-adjusted, no adjustment on assembly
- No elastomer bonding required

TYPES OF INDUSTRIES

- Water, water treatment
- Hydraulic energy
- Paper mills
- Mines
- Chemical
- Refineries
- Sugar factories
- Agri-food
- Pharmaceutical
- Steel industry

EQUIPMENTS

- Pumps
- Mixers
- Dryers
- Cookers
- Water turbines
- Agitators

INSTALLATION

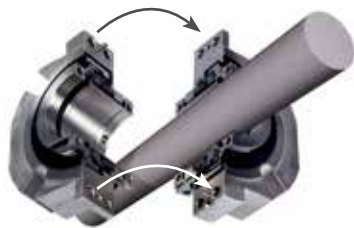

1 Position on the shaft

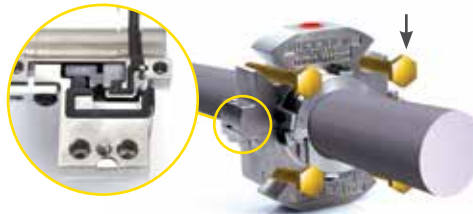

2 Screw the two sub-assemblies and fix on the body of the equipment



3 Release the setting clamp

OPERATING PARAMETERS (not associated)

Ø 45 mm to 75 mm

- Temperature : 170 °C (338°F)
- Speed : 3600 r/mn
- Pressure : <17 bar (1,7 MPa)

Ø 80 mm to 95 mm

- Temperature : 170 °C (338°F)
- Speed : 1800 r/mn
- Pressure : <14 bar (1,4 MPa)

Ø 100 mm to 120 mm

- Temperature : 170 °C (338°F)
- Speed : 800 r/mn
- Pressure : <10 bar (1 MPa)

Ø > 120 mm

- Temperature : 170 °C (338°F)
- Speed : 800 r/mn
- Pressure : <7 bar (0,7 MPa)

MATERIALS

- Flange, sleeve, screw : stainless steel 316 (1.4401)
- Spring : hastelloy C
- Stationary seal surface : carbon or silicon carbide
- Rotary seal surface : silicon carbide
- O-ring : FKM

* Flex-A-Seal, Inc



DETAILED DESCRIPTION - LATTY CARTseal® B25



Rapid and simple installation of split cartridge

Contributes to elimination of the two main causes of premature failure of split cartridges:

- incorrect cartridge installation
- component damage (friction surfaces, O-rings and springs) due to incorrect handling during assembly.

1 Real adjustment clips

- Allowing correct alignment and adjustment of the seal assembly, which helps to eliminate the main cause of failure in split cartridges.
- Absence of measurement and tools.

2 Friction surfaces protected by a metal sleeve

- Contamination cannot infiltrate between the friction surfaces.
- Metal components protect the surfaces from any damage related to incorrect handling.

3 Hydraulically balanced

- Reduction of heating of the cartridge's friction surfaces.
- Offers a greater pressure range in use.

4 Optimum positioning of friction surfaces

- The seal ensures optimum contact of the friction surfaces, as well as their alignment.
- Wide diameter semi-dynamic O-ring eliminating any damage to the shaft or sleeve due to friction.

5 Multiple protected springs

- Absence of contact with the fluid to be sealed.
- Non-adhesive and corrosion resistant.
- Maintained springs avoiding any potential loss of one or more springs during installation.
- Springs not subject to strain during rotation.

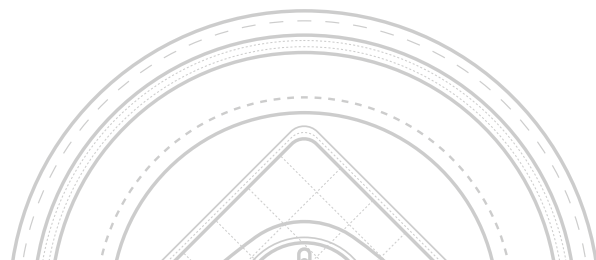
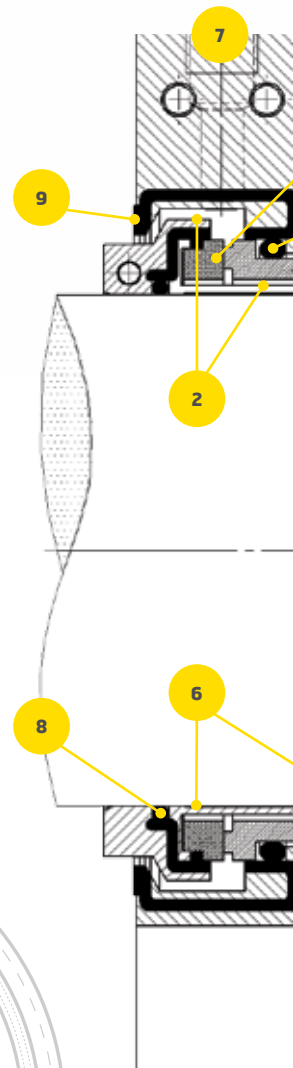

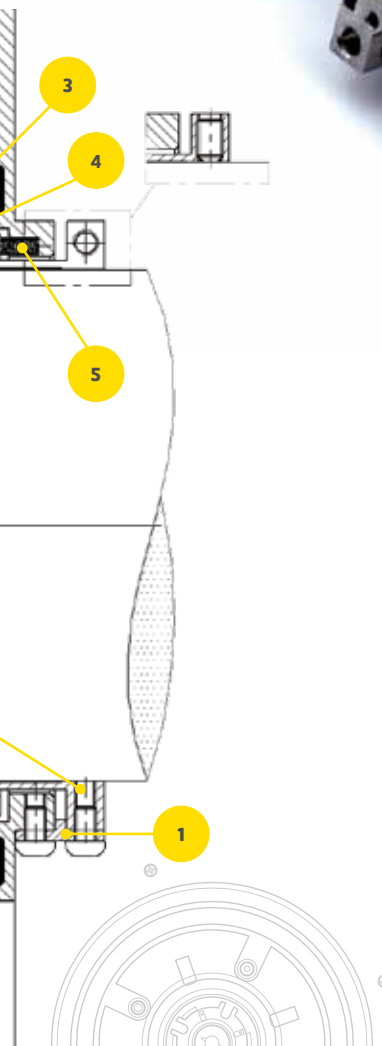

6 High-performing driving rotation components

- Sleeve drive pins ensure perfect rotation of the rotary face.
- Tightening screws maintain the seal in place allowing improved pressure capacity.

7 Flushing rinse connection

- Contributes to improving the lubrication of the mechanical seal.
- Allows for drainage of the mechanical seal.
- Rinsing guarantees greater seal reliability.
- NPT (3/8) or 1/4 gas connection on request.

8 O-ring of the sleeve seal situated on the outside of the sealing box housing

- Important when changing from packings to mechanical seals, the surface of the shaft or sleeve surface is not damaged.

9 Wider, thicker body gasket

- Additional thickness enables improved sealing of slight imperfections of the contact surface with the turning equipment.

« Agitation » version

- Equipment such as agitators and mixers are known to have a wider radial clearance than a classic pump.
- Larger radial clearances allowing wider shaft movement without damaging the seal components.
- It is extremely important for the long-term life of the seal to use a seal specifically designed for mixers and agitators.



LATTY INTERNATIONAL S.A.
57 bis, rue de Versailles
91400 ORSAY - FRANCE
Tel. +33 (0)1 69 86 11 12
sales-marketing@latty.com

LATTY ARGENTINA S.A. *
Nuestra Sra. de la Merced 5334
(1678) CASEROS PCIA. DE BS. AS.
ARGENTINA
Tel. +54 (11) 4734 8481
ventas@latty.com.ar

LATTY BELGIUM S.A./N.V.
Chaussée de Namur 92 bte 07
1300 WAVRE - BELGIUM
Tel. +32 (0)10 24 62 08
info@latty.be

LATTY DICHTUNGSTECHNIK A.G. *
Henzmannstrasse 39
4800 ZOFINGEN - SWITZERLAND
Tel. +41 (0)62 752 20 84
latty@Bluewin.ch

LATTY IBERICA S.L.ESTANQUEIDAD
Pedro IV, 29-35, 4º 6ª
08018 BARCELONA - SPAIN
Tel. +34 (93) 356 99 90
latty@latty.es

LATTY INTERNATIONAL Ltd *
Westfield Road - RETFORD
Notts, DN22 7BT - ENGLAND
Tel. +44 (0)1 777 708836
sales@latty.co.uk

LATTY MAROC TECHNISEALS S.A.R.L. *
51, rue Hadj Ahmed Balafrej -
B.P. 3167
20290 CASABLANCA - MOROCCO
Tel. +212 (0)5 22 24 80 90
lattymaroc@menara.ma

LATTY 2RS GmbH *
Im Auel 22
D-53783 - EITORF
GERMANY
Tel. +49 (0)2243 / 84658-0
latty2rs@latty.de

LATTY SOUTH AFRICA Ltd *
108 Billingham Rd, Founders View South
Modderfontein, Edenvale, 1610
SOUTH AFRICA
Tel. +27 (0)11 452 9755
support@latty.co.za

LATTY Seal Services
Service center for mechanical seals repair
and repackaging

LATTY MECASEAL
2, impasse du Crachet
Zone Artisanale
59193 ERQUINGHEM - LYS
FRANCE
Tel. +33 (0)3 20 77 12 89
lattyseal.service@latty.com

LATTY MECANETANCHE
174, rue des Saules
Z.I. Le Chapelier
38110 SAINT-JEAN DE SOUDAIN
FRANCE
Tel. +33 (0)4 74 97 01 09
lattyseal.service@latty.com



Split mechanical seals
CARTseal® B25

*Subsidiaries with workshop for mechanical seals repair and repackaging.



PLANT
1, rue Xavier Latty - F-28160 BROU, FRANCE
Tel. +33 (0)2 37 44 77 77. Fax. +33 (0)2 37 44 77 99
customerservice@latty.com

www.latty.com

